

Product data sheet



Information

Designation	Wash-hand basin with round sink, 170 x 340 x 340 mm, Bright polished Stainless steel, tube Ø 275 mm
Reference	063500

Product advantages

- Tap with knee-operated push-button control.

Description

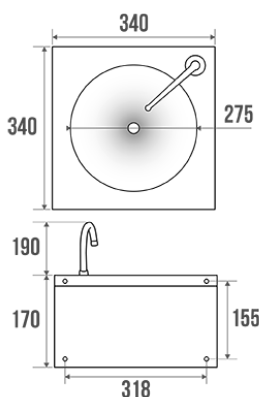

AISI 304 Stainless steel.
Round sink.
Tap with knee-operated push-button control.
Supplied with a mixer tap hot water - cold water and siphon. The mixer tap is supplied with a non-return valve.
Stainless steel fixing screws 6 x 40 mm included.
Connection to water network couplings 15/21.
NF alimentary hygiene.
Round sink, capacity: 5 litres.

Perfectly suited for use in Institutions.

Technical characteristics

Finish	Bright polished
Dimensions	170 x 340 x 340 mm
Diameter Ø	275 mm
Capacity (litres)	5 L
Material	Stainless steel
Gross weight	4.100 kg
Packaging	Cardboard box
Made in France	yes
Maintenance	yes
Guarantee	1 year
Gencod	3563390635001
Custom code	7324900010
Technical sheet	A06350001

Fixing and maintenance advices

Fit the lower part at 700 mm from the ground.

Fiche produit mise à jour le : 10/01/2024