

Product data sheet



Information

Designation	90° angled link support, 126.5 x 136 mm, White Polyamide (Nylon), tube Ø 33 mm
Reference	046530

Description

White polyamide (nylon).
Tube Ø 33 mm.
White flange border.
Concealed fixings.

Stainless steel fixing screws included (5,5 x 45 mm).

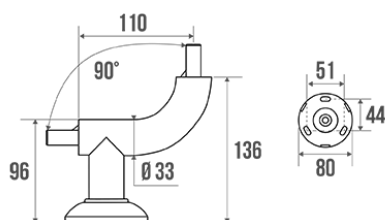

Technical characteristics

Color	White
Dimensions	126.5 x 136 mm
Diameter Ø	33 mm
Material	Polyamide (Nylon)
Gross weight	0.318 kg
Packaging	Printed cardboard box
Made in France	yes
Maintenance	yes
Guarantee	10 years
Gencod	3563390465301
Custom code	3922900000
Technical sheet	S00001190_IND_08
Spare parts	Ref. 046100, Polyalu cover plate. Ref. 046102, Fixing kit.

Fixing and maintenance advices

Fits into a straight section. Careful consideration and selection of the appropriate wall fixings according to the wall-mounted support is required to ensure the long life of your accessory. The use of stainless steel screws (\varnothing 4 mm) is highly recommended to prevent corrosion in damp environment. Before drilling, physically hold the product against the wall at desired position and mark the hole locations. All the fixing points must be respected. After installation and before use, make sure that all fixing screws are tightened securely.

Fiche produit mise à jour le : 10/01/2024