

## Product data sheet



### Information

Designation	Toilet roll holder, 132 x 66 mm, White Epoxy-coated Steel, tube Ø 25 mm
Reference	013500

### Product advantages

- Invisible fasteners.

### Description

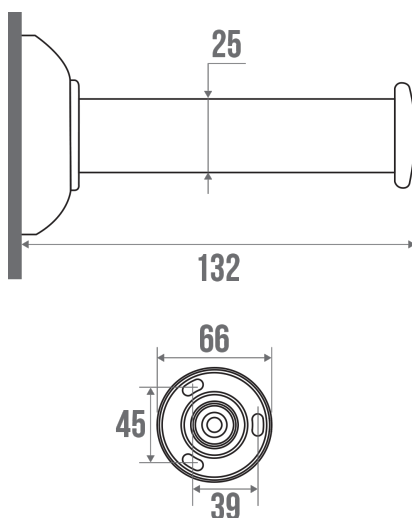

Concealed fixings.  
White synthetic resin flange and cover plate.  
Steel tube Ø 25 mm.

Wall fixings not included.  
Range coordinated with our white epoxy-coated aluminium grab bars.

### Technical characteristics

Finish	Epoxy-coated
Color	White
Dimensions	132 x 66 mm
Diameter Ø	25 mm
Material	Steel
Gross weight	0.220 kg
Packaging	Plastic protection bag
Made in France	yes
Maintenance	yes
Guarantee	1 year
Gencod	3563390135006

Custom code	7324900010
Technical sheet	<a href="#">S00001461_IND_10</a>
Spare parts	Ref. 013008, Flange (per piece). Ref. 049000, White cover plates (per pair). Ref. 049005, White cover plate (per piece).

## Fixing and maintenance advices

---

Careful consideration and selection of the appropriate wall fixings according to the wall-mounted support is required to ensure the long life of your accessory. The use of stainless steel screws ( $\varnothing$  4 mm) is highly recommended to prevent corrosion in damp environment. Before drilling, physically hold the product against the wall at desired position and mark the hole locations. All the fixing points must be respected. After installation and before use, make sure that all fixing screws are tightened securely.

Fiche produit mise à jour le : 10/01/2024