

Product data sheet



Information

Designation	Toilets multifunctional grab bar to lift up
Reference	048511

Product advantages

- + **Built-in accessories : no extra drilling.** Ideal for small spaces.
- + **Easy setting : pre-drilled bars.**

Description

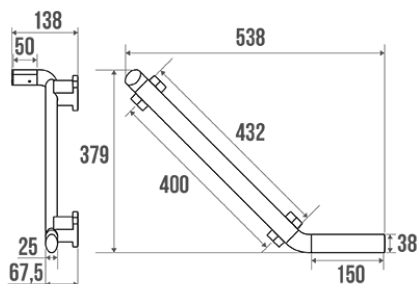

Elliptical aluminium tube 38 x 25 mm, polymer fixing covers.
Concealed fixings.

Available for the toilet area, with a toilet roll holder and robe hook so as to hang small objects or clothes up : cane, hand bag, hat, scarf.

Pre-drilled tubes every 50 mm in order to set the accessories according to the desired height and side : left version.

Technical characteristics

Diameter Ø	38 x 25 mm
Material	Aluminum
Packaging	Cardboard box
CE Marking : safe load	150 kg
Laboratory tests	225 kg
Made in France	yes
Maintenance	yes
Guarantee	10 years
Gencod	3563390485118
Custom code	7615200000
Technical sheet	A04841001_IND_04

Fixing and maintenance advices

Recommended height for the horizontal part : 800 mm from the ground. Grab bars provide support and added safety if properly fitted in accordance with our technical instructions. Careful consideration and selection of the appropriate wall fixings according to the wall-mounted support is required to ensure the long life of your accessory. The use of stainless steel screws (Ø 4 mm) is highly recommended to prevent corrosion in damp environment. Before drilling, physically hold the product against the wall at desired position and mark the hole locations. All the fixing points must be respected. After installation and before use, make sure that all fixing screws are tightened securely. **DO NOT** use the grab bar as a step. **DO NOT** sit on or hang from the grab bar.

Fiche produit mise à jour le : 10/01/2024